

### Tools required

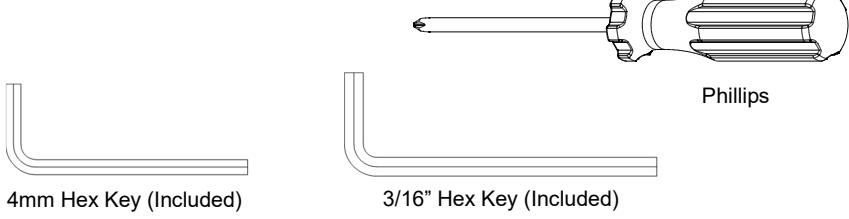

**DO NOT USE POWER TOOLS**

### Hardware (Included)

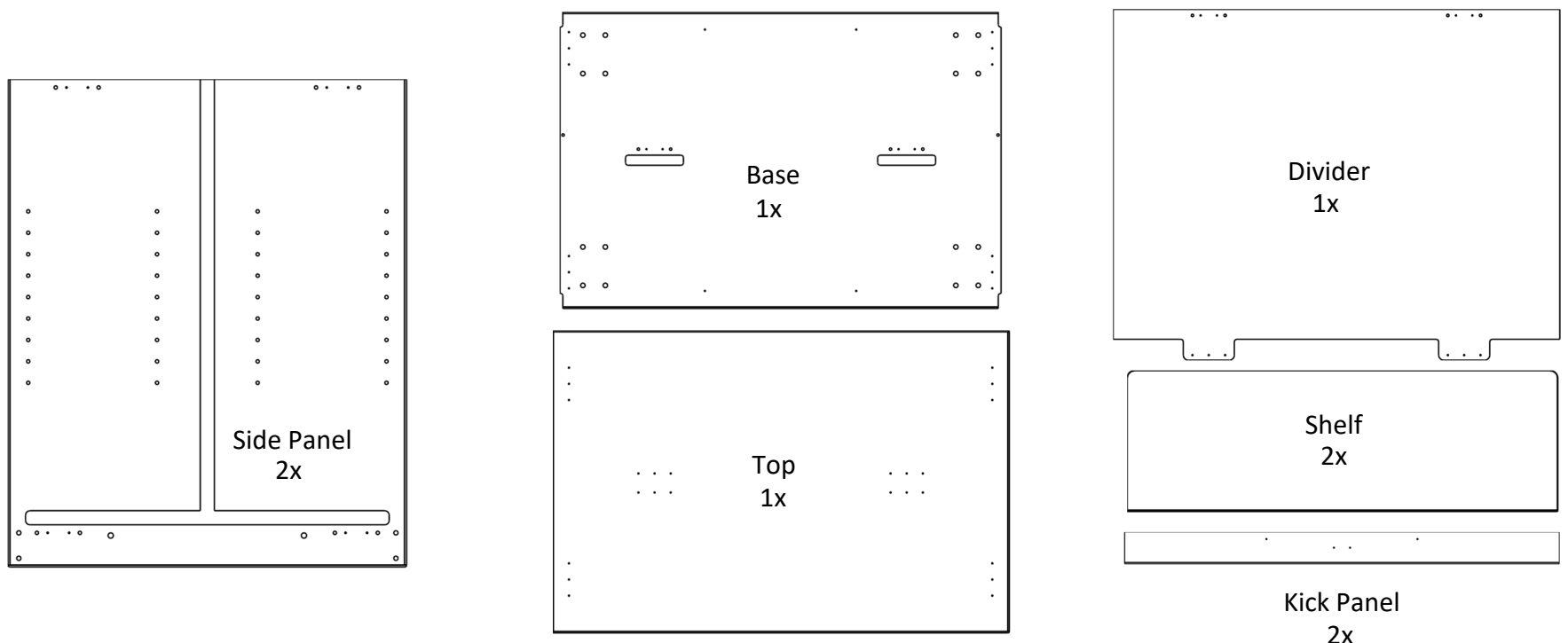
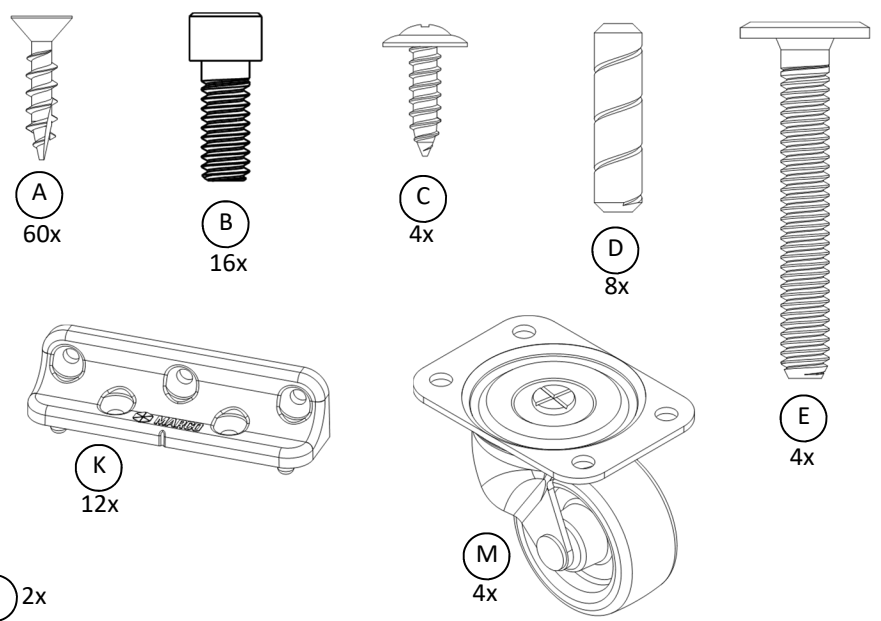

**1** Attach (4) blocks "K" to Side Panels with Screws "A" as shown. **NOTE THE ORIENTATION OF THE BLOCKS WHEN FASTENING.** Repeat for both Side Panels.

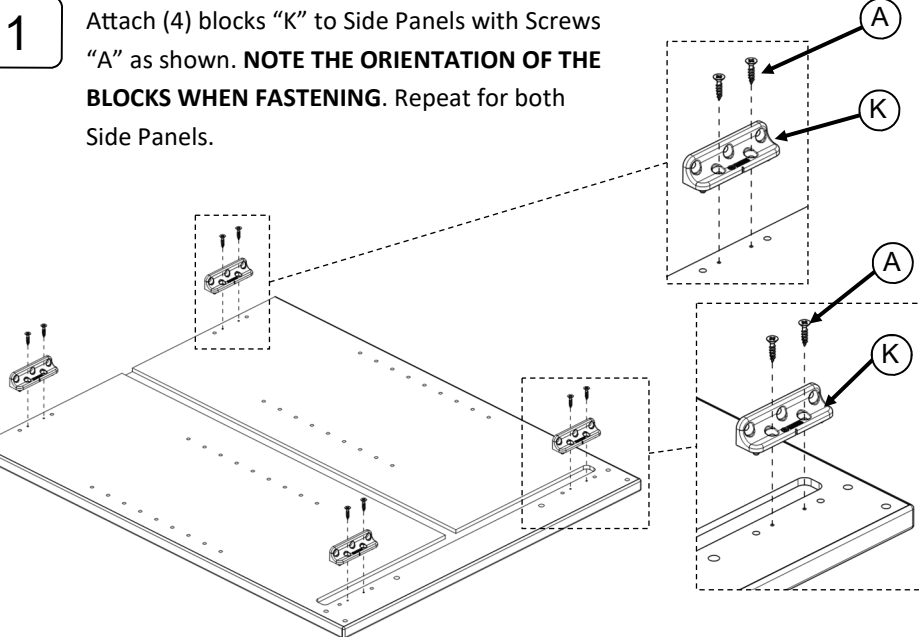

**3** Attach Base assembly from Step 2 to Side Panel from Step 1 using Screws "A".

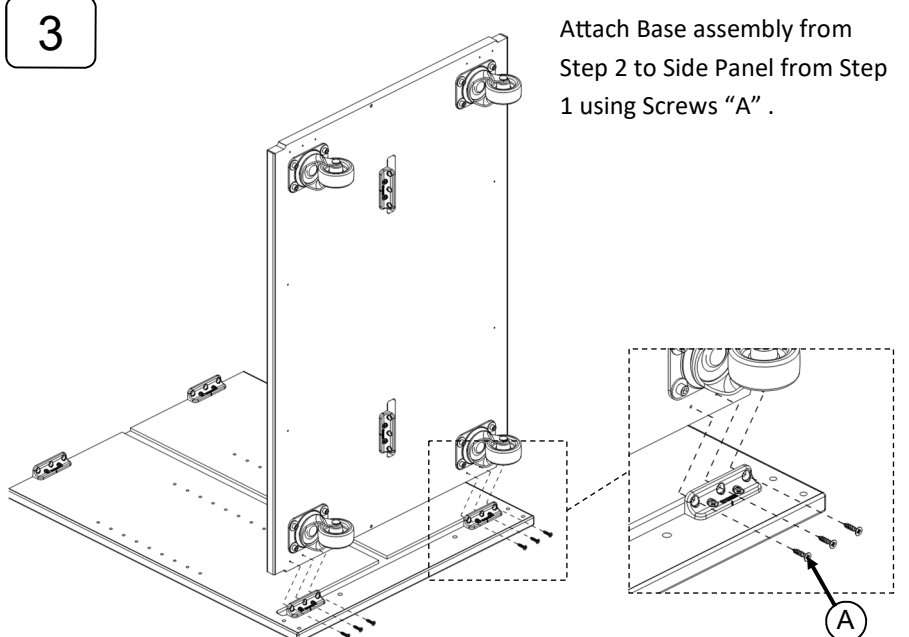

**2** Attach (2) blocks "K" to Base with Screws "A" as shown. **NOTE THE ORIENTATION OF THE BLOCKS WHEN FASTENING.** Attach casters using Bolt "B", Washer "J", and Cap Nut "G".

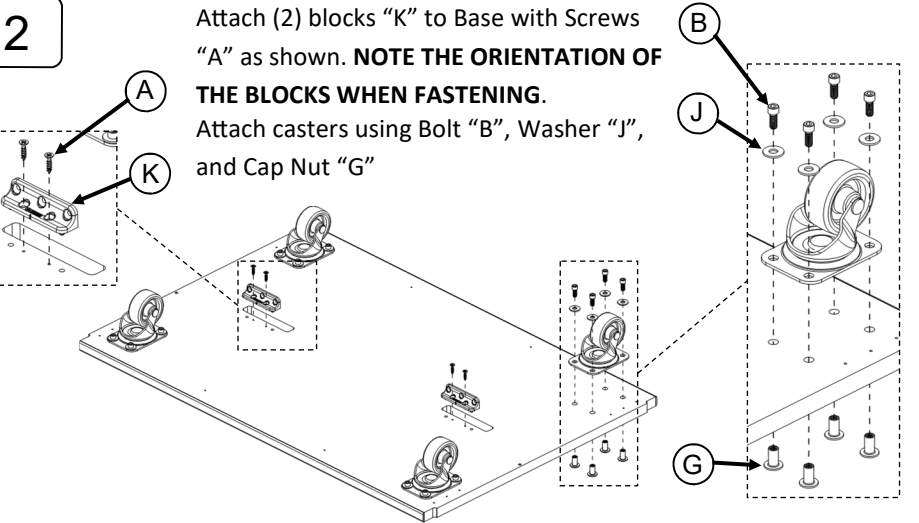

**4** Attach (2) blocks "K" to Divider with Screws "A" as shown. **NOTE THE ORIENTATION OF THE BLOCKS WHEN FASTENING.**

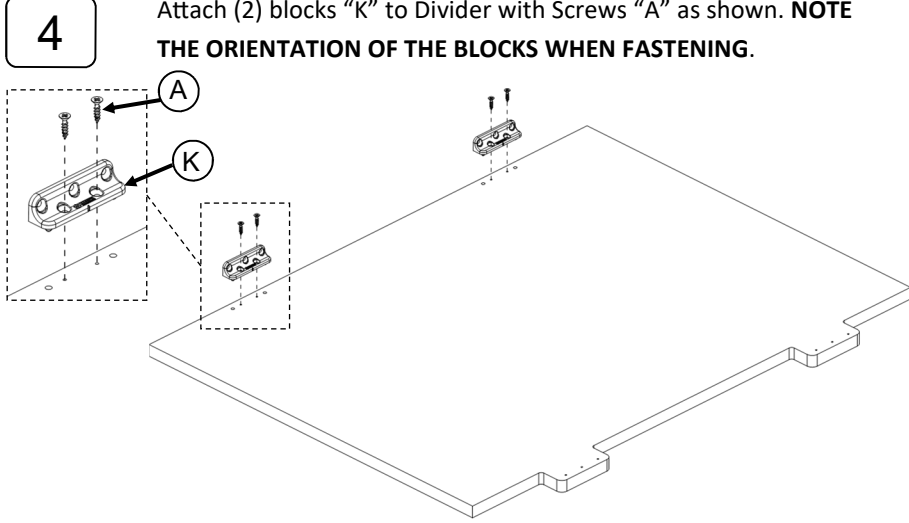

Marco Group, Inc.  
5400 Doniphan Dr.  
Neosho, MO 64850  
www.marcogroupinc.com

Customer Service Hours:  
Monday-Friday 8:30am to 4:30pm CST  
(Except holidays)  
Toll-Free 888-627-2601  
CustomerService@marcogroupinc.com

417-455-9663 - Phone  
417-455-0057 - Fax

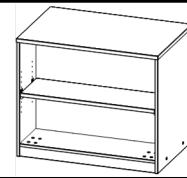

5

Insert tabs on Divider Panel into holes on the Base with the Divider edge in the Side Panel groove making sure the pilot holes align with the fastener block on the Base. Rotate Divider if necessary if pilot holes are on the opposite side. Attach to Base using Screws "A".

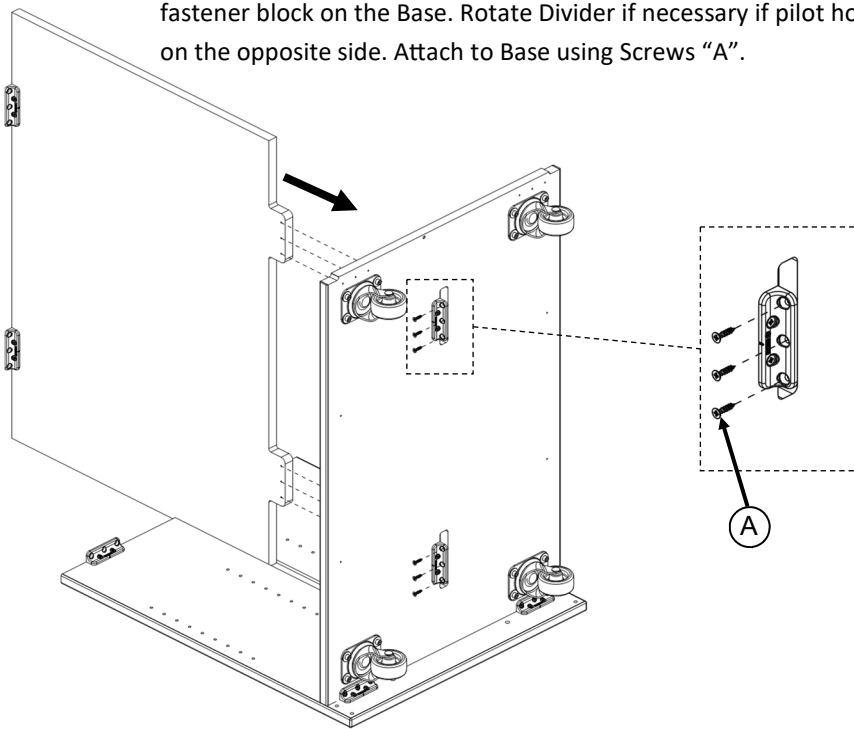

9

Align grooves on Side Panel assembly from Step 1 to Base and Divider panel edges. Make sure wood dowels on Kick Panels align with holes in Side Panel.

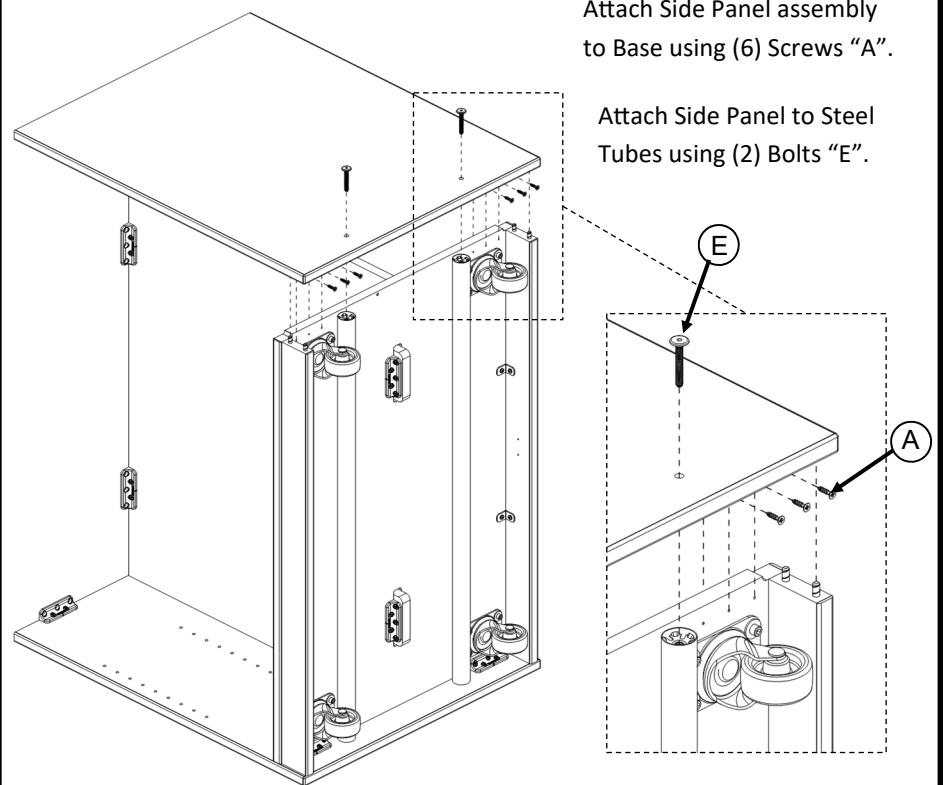

Attach Side Panel assembly to Base using (6) Screws "A".

Attach Side Panel to Steel Tubes using (2) Bolts "E".

6

Attach (2) Bracket "H" to Kick Panel using Screw "F" at predrilled pilot holes near edge. Make sure Bracket is straight & even with panel edge.

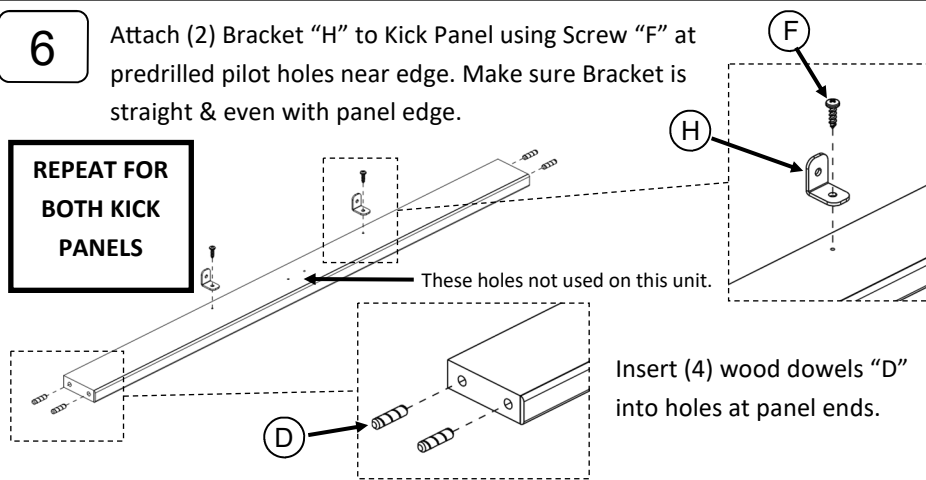

**REPEAT FOR BOTH KICK PANELS**

These holes not used on this unit.

Insert (4) wood dowels "D" into holes at panel ends.

7

Attach Kick Panel assembly from Step 6 by inserting dowels into holes in Side Panel and attach to Base using Screws "F" as shown into predrilled pilot holes. Repeat for both Kick Panels

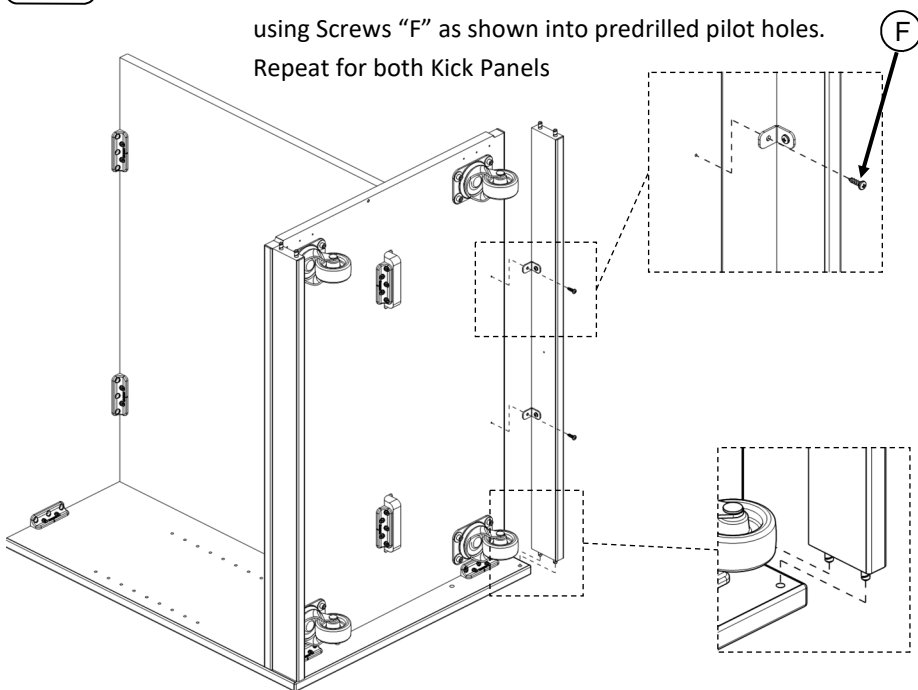

8

Attach Steel Tubes "L" to Side Panel using (2) Bolts "E".

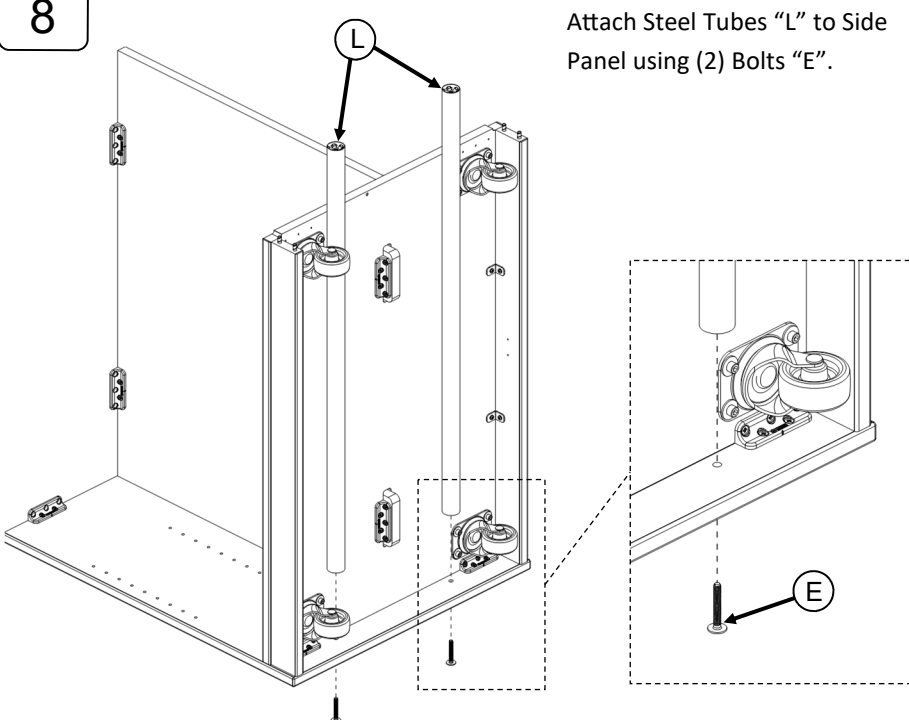

11

Attach Shelf Brackets "I" at desired height by inserting pegs into the Side Panel holes. Slide Shelf into place engaging locking tabs on the Brackets.

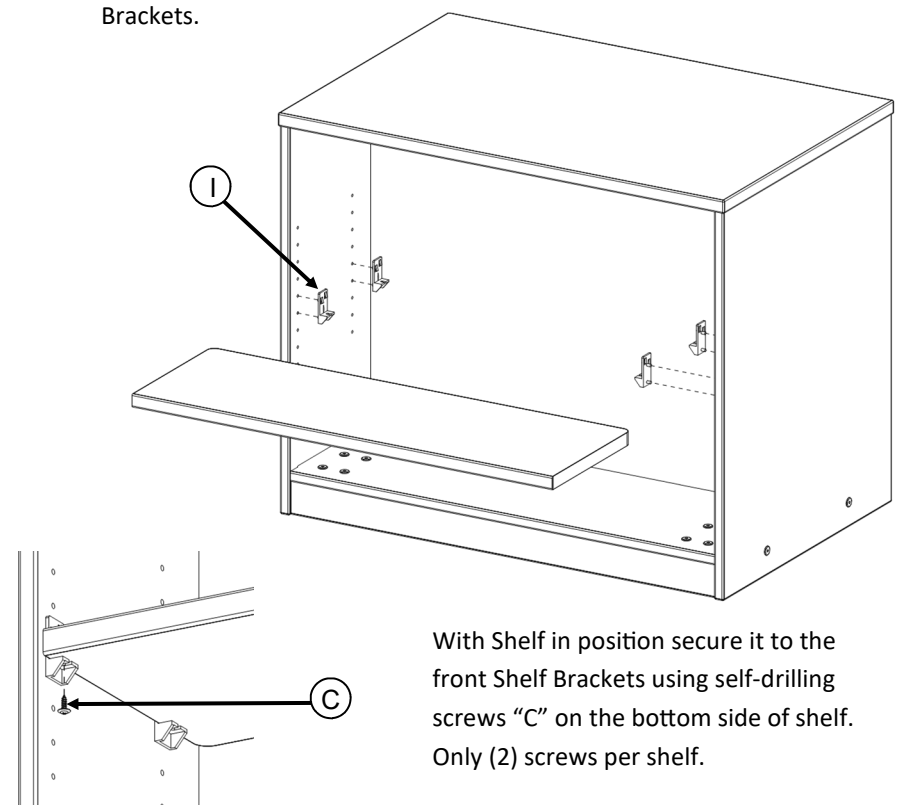

With Shelf in position secure it to the front Shelf Brackets using self-drilling screws "C" on the bottom side of shelf. Only (2) screws per shelf.