



# MARCO

## Seismic Bracket Installation Instructions

75402 Seismic Bracket Kit

#85329

Rev. 12-08-24

Tools required for cabinet attachment  
(Additional tools required for floor/wall attachment)

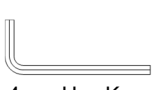

4mm Hex Key

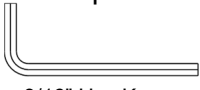

3/16" Hex Key



3/32" Drill Bit

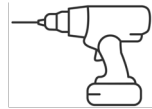

#2 Phillips Screwdriver

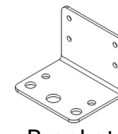

Bracket

Kit Hardware

x4



x16

#8 x 5/8" Screw

**1** Remove all bottom shelf bolts using hex keys.

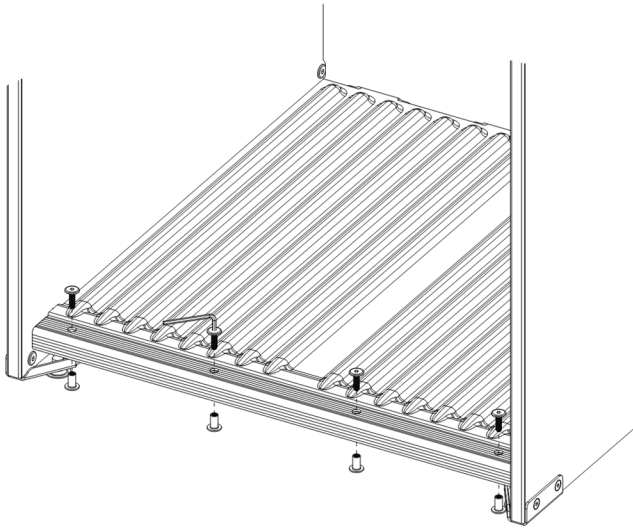

**2** Remove liner cap. Remove plastic shelf liner by rotating up and out of cabinet.

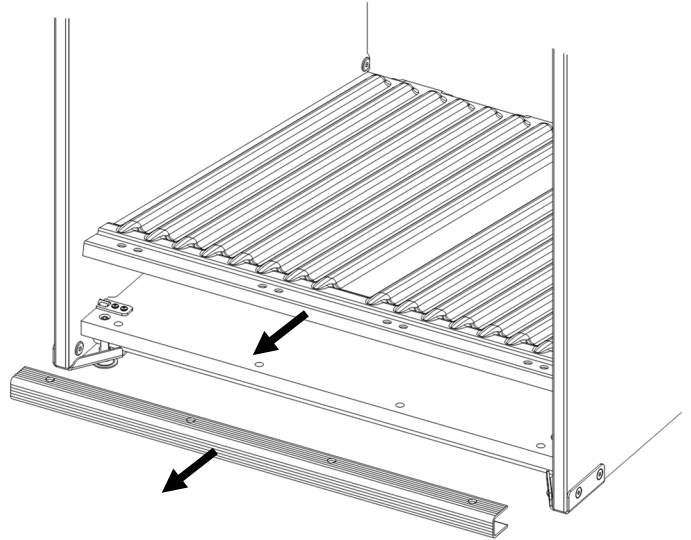

**3** Remove two screws securing the shelf retainer. Remove retainer on both sides of shelf.

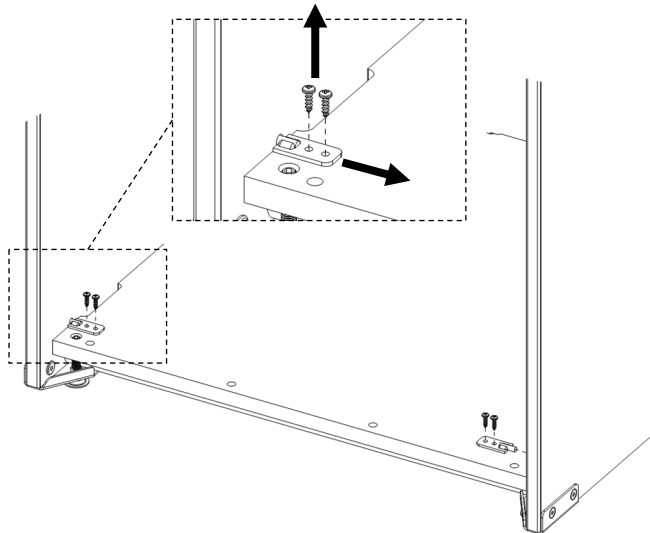

**4** Remove shelf by rotating up and out of cabinet to gain access to floor under cabinet.

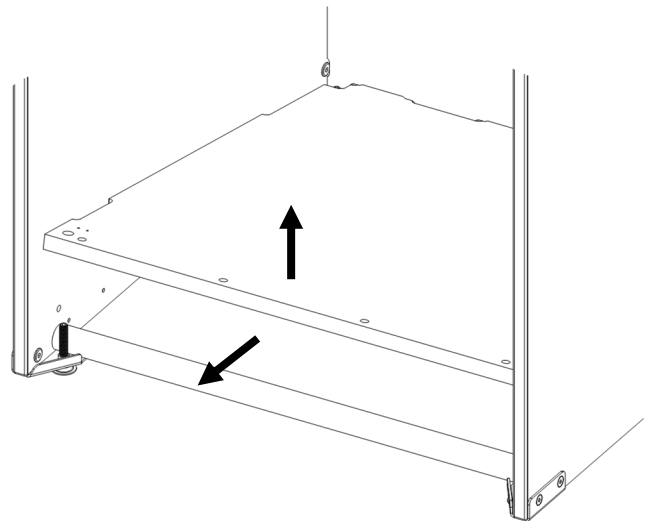

Marco Group, Inc.  
5400 Doniphan Dr.  
Neosho, MO 64850

[www.madebymarco.net](http://www.madebymarco.net)

Customer Service Hours:  
Monday-Friday 8:30am to 4:30pm CST  
(Except holidays)

Toll-Free 888-627-2601  
[CustomerService@marcogroupinc.com](mailto:CustomerService@marcogroupinc.com)

417-455-9663 - Phone  
417-455-0057 - Fax



### 5 Ensure the cabinet is in its final position and level before installing anchor brackets.

With anchor bracket resting on the floor position inside front corner of cabinet as shown between two locating holes drilled in cabinet side. Use bracket to mark cabinet & floor fastener locations. Refer to document #85321 for approved floor anchor fasteners. Drill four 3/32" screw pilot holes 5/8" deep in cabinet side at marked locations. **CAUTION: Pilot drill depth must not exceed 5/8"**. Drill floor for appropriate fasteners. Attach bracket to cabinet sides with four #8 x 5/8" screws per bracket. Anchor bracket to floor. Repeat for opposite front corner of cabinet. Reinstall bottom shelf in reverse order of Steps 1-4.

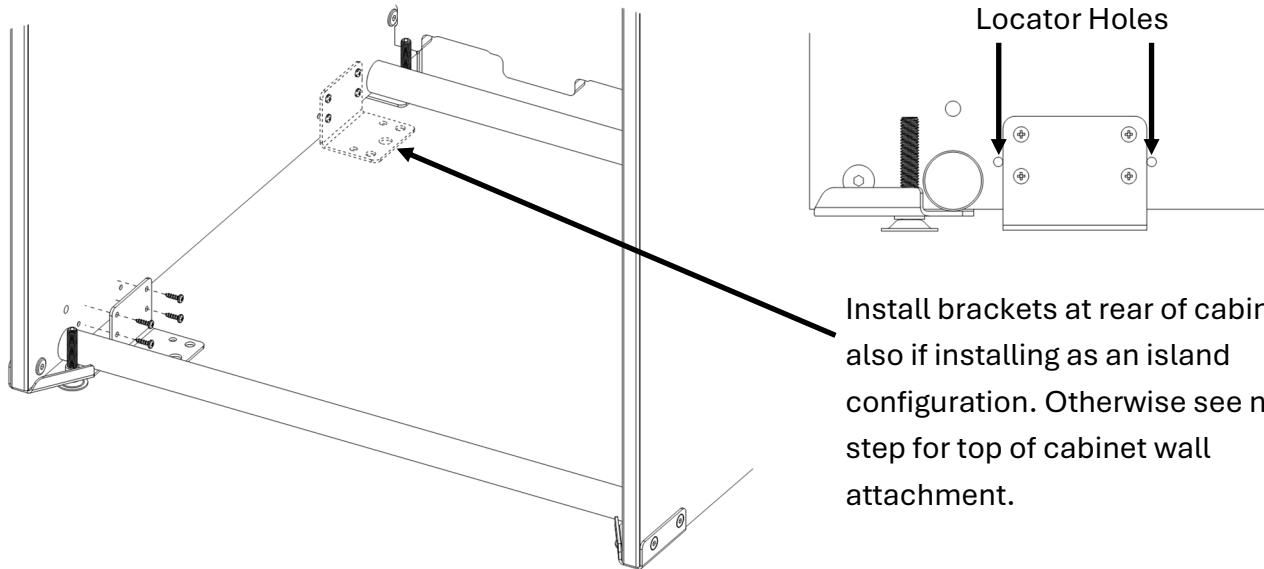

### 6 Refer to document #85321 for wall blocking requirements.

Place two brackets on top of cabinet against wall at 16" O.C. aligned with wall studs/blocking. Pilot drill four 3/32" holes per bracket in cabinet top. **CAUTION: Pilot drill depth must not exceed 5/8"**. Attach brackets to cabinet with four #8 x 5/8" screws per bracket. Attach brackets to wall using suitable fasteners for wall type. Refer to document #85321 for approved fasteners.

